

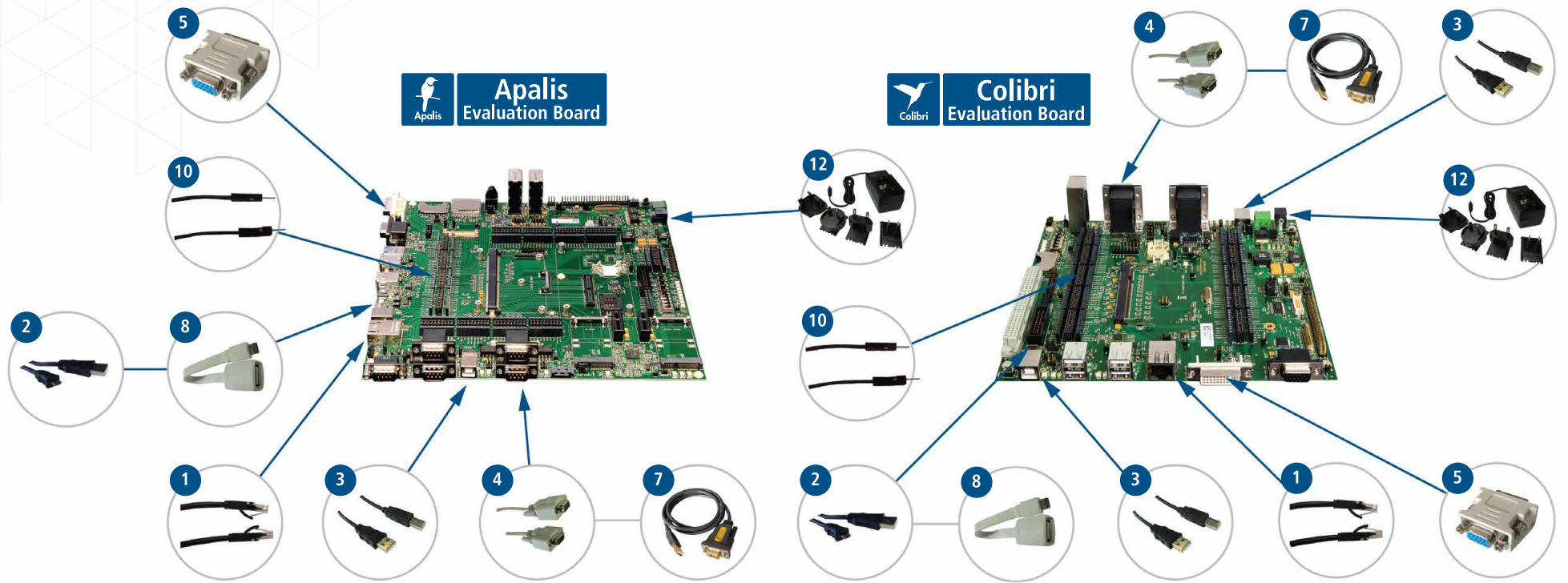

Carrier Board Accessory Kit

V1.1C





Apalis Ixora Carrier Board

Colibri Iris Carrier Board

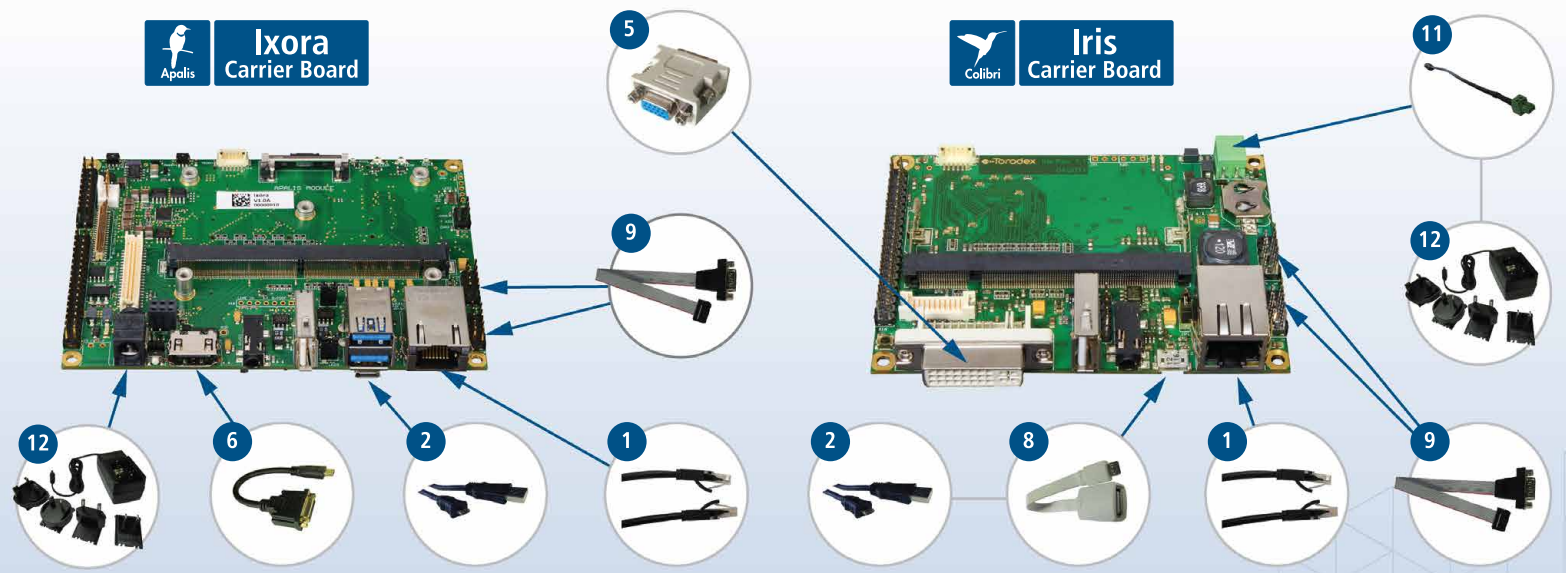

- 1 Ethernet Cable
- 2 USB A to Micro B Cable
- 3 USB A to B Cable
- 4 Null Modem Cable (RS232 Cable)
- 5 DVI to VGA Adapter
- 6 HDMI to DVI Cable
- 7 USB to Serial Adapter
- 8 USB Micro B to A Cable
- 9 Serial Port Adapter (Iris and Ixora)
- 10 Patch Cables
- 11 Power Supply Adapter (Iris Carrier Board)
- 12 1xAC/DC Power Adapter







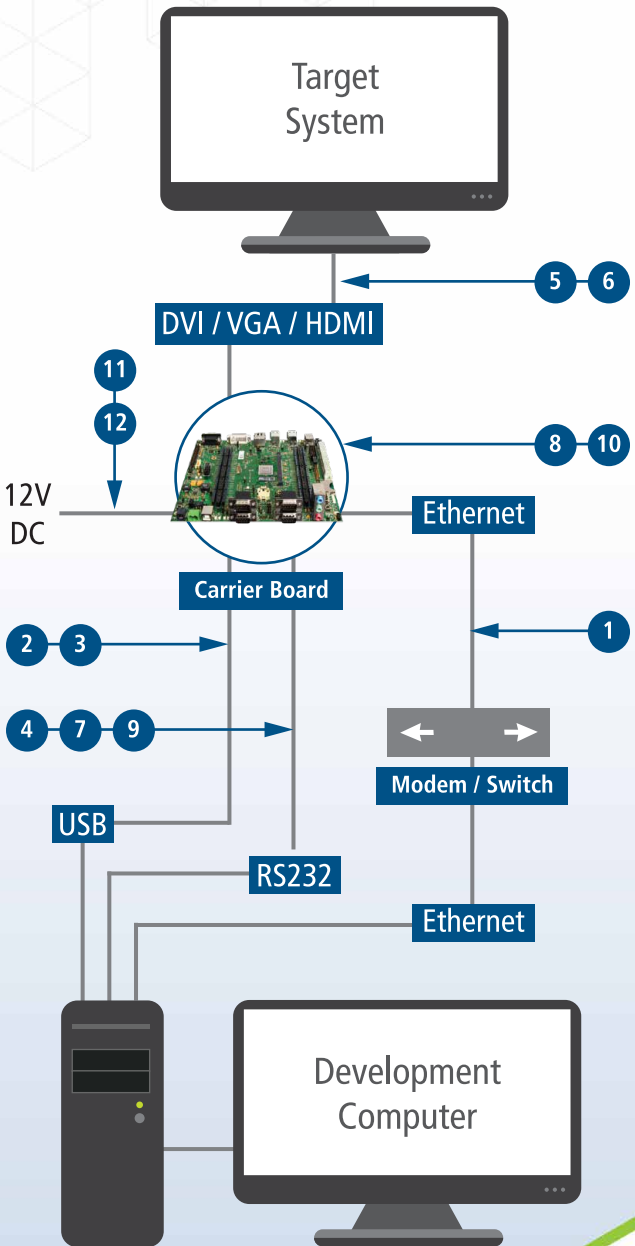





Verdin Carrier Board can use 1,2,4,6,8,9,10, and 12

For details please check: https://developer-archives.toradex.com/products/carrier-board-accessory-kit#Components_included_and_compatibility

Accessory Settings



Accessory List

No.	Name	Qty.	Size
	Ethernet Cable	1	2m
	USB A to Micro B Cable	1	1.5m
	USB A to B Cable	2	1.5m
	Null Modem Cable (RS232 Cable)	1	1.5m
	DVI to VGA Adapter	1	-
	HDMI to DVI Cable	1	15cm
	USB to Serial Adapter <small>Note 1</small>	1	1m
	USB Micro B to A Cable	1	10cm
	Serial Port Adapter (Iris and Ixora)	2	20cm
	Patch Cables	12	20cm
	Power Supply Adapter (Iris Carrier Board)	1	20cm
	1xAC/DC Power Adapter	1	1.2m

Toradex | www.toradex.com | info@toradex.com

Note 1: For additional Linux drivers, see link below
developer.toradex.com/product-selector/carrier-board-accessory-kit